

Agitators With External Electric Motor HMT



ATEX version available



Agitators With External Electric Motor HMT

HIGHLY EFFICIENT, RELIABLE AND PRACTICAL

HMT Agitators with External Electric Motor are designed for optimised performance in environments such as anaerobic digesters, digestate tanks and pre-tanks.

The specially shaped stainless-steel propeller ensures highly efficient mixing, even with effluents rich in solids.

Each model has a modular design with propellers of different shapes and sizes, in order to maximise the balance between performance and energy consumption.

The agitators are installed on the side of tanks, integrating perfectly with a mounting frame in concrete. A distinctive advantage of the HMT B (bi-directional) model is the ability to adjust both horizontally and vertically, offering high operational flexibility.

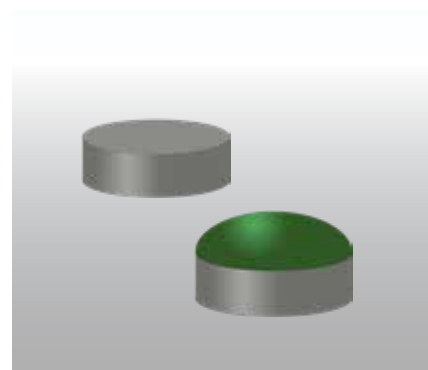

Applicable on both concrete-ceilinged and membrane-roofed tanks

Overall dimensions

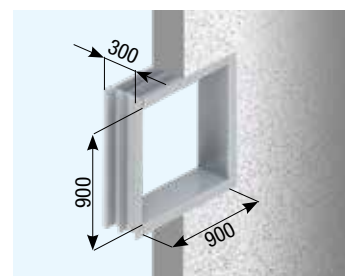
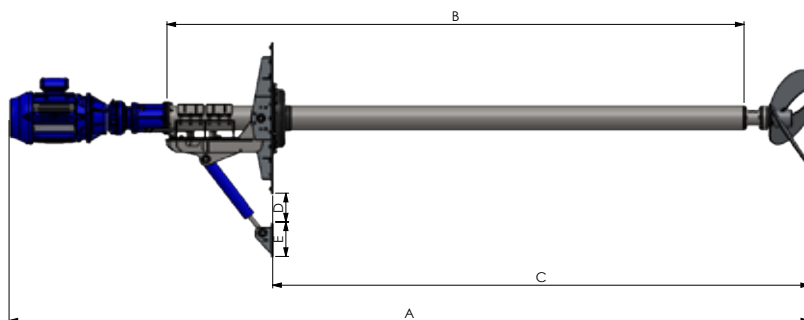
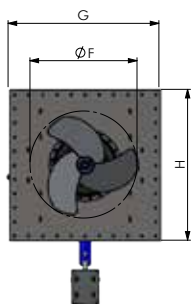

Wall mounting frame

Model	Power (kW)	Length (m)	Dimensions (mm)							
			A	B	C	D	E	F	G	H
HMT B	11.0	2	3,560	2,000	2,750	200	240	650	1,050	1,050
		3	4,560	3,000	3,750					
		4	5,560	4,000	4,750					
	15.0	2	3,605	2,000	2,750			740		
		3	4,605	3,000	3,750					
		4	5,605	4,000	4,750					
	18.5	2	3,630	2,000	2,750			770		
		3	4,630	3,000	3,750					
		4	5,630	4,000	4,750					
	22.0	2	3,670	2,000	2,750			800		
		3	4,670	3,000	3,750					
		4	5,670	4,000	4,750					

Benefits

- ✓ **Outstanding energy savings:** Thanks to innovative propeller profile, high energy efficiency is achieved at minimal long-term costs.
- ✓ **Advanced mixing:** Engineered 3-blade propeller offers powerful mixing effect, ensuring homogeneity in mixing processes.
- ✓ **Maximum versatility:** Bi-directional adjustment is practical and flexible, adapting to specific process requirements.
- ✓ **Easy installation and maintenance outside the tank** simplifying operations, reducing downtime and associated costs.

Technical Features

- Dynamically balanced 3-blade 304 stainless-steel propeller
- 304 stainless-steel external tube $\varnothing 168.3$ mm
- Modular 304 SS $\varnothing 88.9$ mm internal transmission tube
- C40 steel transmission shaft $\varnothing 35$ mm in oil-bath
- Elastic coupling between gearbox and drive shaft
- Refill container and oil level control
- Bearing support with cemented carbide mechanical seal
- Independent $\varnothing 50$ mm AISI 304 shaft and pair of tapered roller bearings
- Agitator structure completely made of 304 stainless steel
- EPDM rubber sealing membrane
- 304 stainless-steel wall mounting frame



ATEX version available

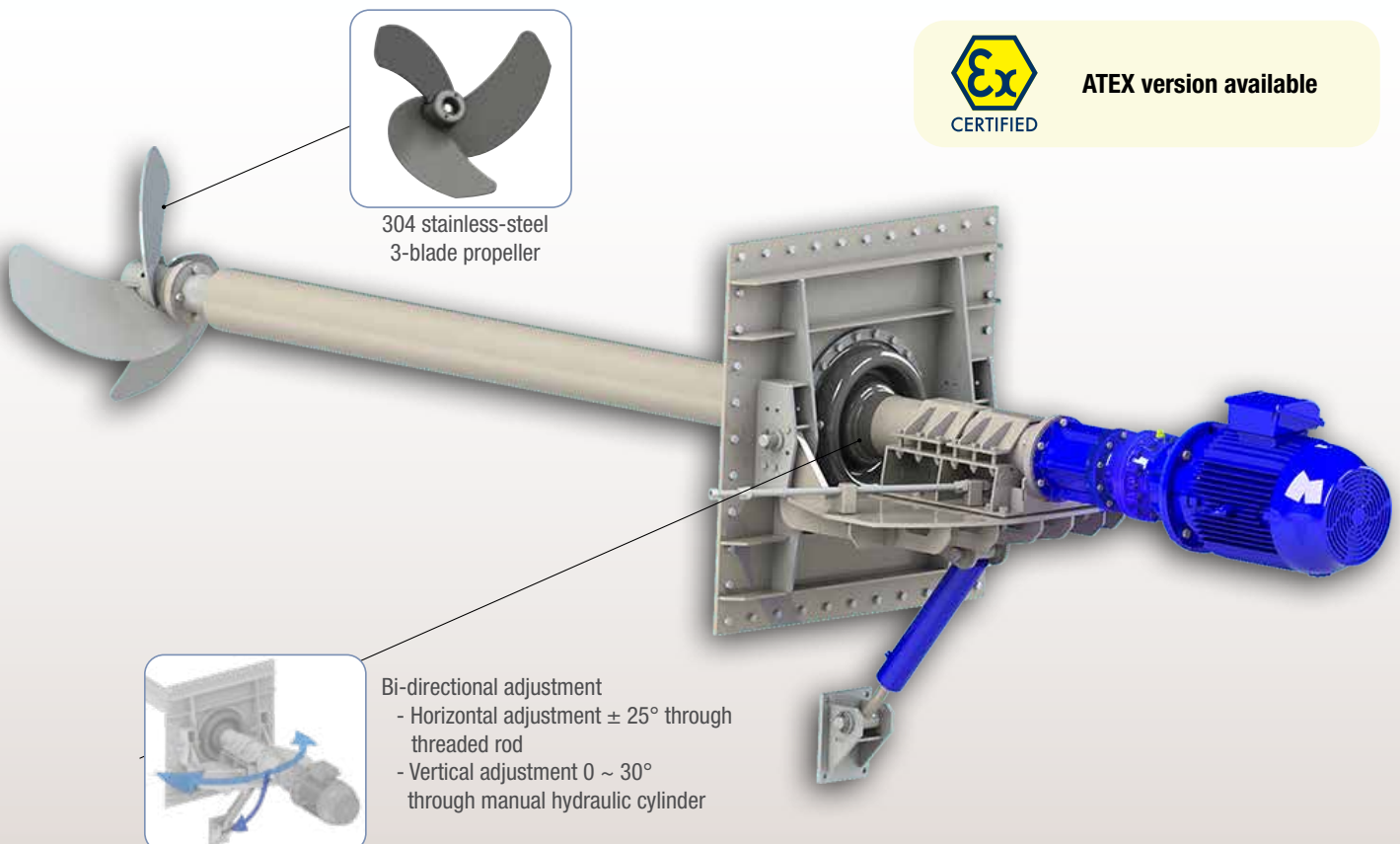

304 stainless-steel
3-blade propeller

- Bi-directional adjustment
- Horizontal adjustment $\pm 25^\circ$ through threaded rod
 - Vertical adjustment 0 ~ 30° through manual hydraulic cylinder

Range Performance

Type	Power (kW)	Speed (rpm)	Ø Propeller (mm)	Voltage (V)	Frequency (Hz)	Thrust (N)	Flow rate (m³/h)	Nom. power (A)
HMT B 110	11.0	280	650	400/690	50	2,902	5,790	22
HMT B 150	15.0	280	740	400/690	50	3,885	8,280	29
HMT B 185	18.5	280	770	400/690	50	5,780	11,690	34
HMT B 220	22.0	280	800	400/690	50	5,998	12,300	40

Application



00000000 October 2023 Rights reserved to modify technical specifications.

This brochure has been edited for distribution in European Union countries



www.saveco-water.com